

Product data sheet

Plus

AR8184



ARRONE ball bearing hinge:

- Material: Stainless Steel
- Hinge Grade: Grade 13
- Shape: Square
- Unit of measure (pack size): Sold as a pair
- Door weight: Suitable for doors weighing up to 120 kg
- Fixing: 16 x stainless steel pozidrive countersunk wood screws
- Testing: **BS EN 1935:2002** (Classification: 4 | 7 | 6 | 1* | 1 | 4 | 0 | 13); **BS EN 1634** Part 1.
Assessed for use on 30 and 60 minutes timber fire doors and 240 minutes on steel fire doors.
- CE Marked: AC0070, UKCA Marked: AC7678
- Certifire approved: CF369, CE DOP: HUK0017, UKCA DOP: HUK0017-UK

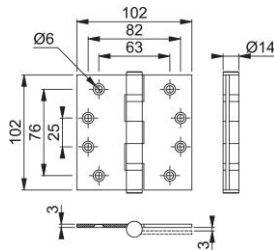

Article number	89002114
Product ref.	AR8184-SSS-A1-O
EAN-Code	5051358069756
Country of origin	China
CN-Code	83021000
Dimension	102x102 mm
Door type	wooden door
Fixings	Timber door
Dimensions	102x102x3 mm
Bearing	2 Ball Bearing Hinge
Shape	
Leaf corner	square corners
Drill	4 holes template drilled, countersunk
Material thickness	3 mm
Finish	Satin Stainless Steel
Range	ARRONE Range
Packing unit	2
Outer carton	36